

PARTS LIST - MODEL HSG 200/400 SEE FIG. 15 & FIG. 17

Item	Part No.	Description
1.	100934-001	Burner Housing
2.	62576-003	Air Tube - HSG200 6" (152.4mm)
	63270-004	Air Tube - HSG400 6 1/4" (158.75 mm)
	62576-015	Air Tube - HSG200 9" (228.6mm)
	63270-015	Air Tube - HSG400 9" (228.6mm)
	62576-027	Air Tube - HSG200 12" (304.8mm)
	63270-027	Air Tube - HSG400 12" (304.8mm)
	63270-028	Air Tube - HSG400 15" (381 mm)
3.	62393-001	Air Cone - (HSG200 only)
4.	21724-011	Adjustable Flange Assembly (includes gasket)(not shown)
5.	100428-002	Flange Gasket (not shown)
6.	21664	Blower Wheel HSG200 5 1/4" OD (133.35mm)
	21642	Blower Wheel HSG400 5 1/2" OD (139.7mm)
7.	21658	Side Plate (Used with 20627 and 20627-004 Motors Only)
8.	20627	Motor, Split Phase 1/7 (.107kW) or 1/8 (.093kW) HP 3450 RPM 115V/60
	20627-004	Motor, Split Phase 1/7 (.107kW) HP 2850 RPM 230V/50Hz (220V/50Hz)
9.	100373-002	Combustion Air Inlet Damper
10.	62408-001	Control Box (S89E & S89F)
11.	62388-001	30 Sec. Prepurge Time
	62530-001	Resistor Wire Assy.
12.	60186-004	24 Volt Transformer 120V
	63005-002	24 Volt Transformer 220V
	100450-001	Bushing
13.	62406-002	Motor Relay
14.	62759-002	Primary Safety Control H'Well S89F w/30 Sec Prepurge (220V/50Hz)
	62758-002	Primary Safety Control H'Well S89E w/o 30 Sec Prepurge (Special Limit Applications Only)
15.	100377-002	Damper Indicator Pointer
16.	100429	Damper Decal
17.	63263-005	Pressure Switch
	63272-005	Pressure Switch Conversion Kit
	63935-001	Pressure Switch (220V/50Hz)
18.	60178-002	Thermostat Terminal Strip
19.	100372	Adjustment Arm Off-Cycle Damper
	20-21.	100371-KIT Off-Cycle Damper Kit
22.	21319	Junction Box (under Ignition Transformer)
23.	61843	Lighting Plate
24.	62407-001	Ignition Transformer 7500V
	64051-001	Ignition Transformer 220V/50Hz Danfoss
25.	62391-002	Electrode Assembly
26.	62390-002	Sensor Probe Assembly
27.	62387-001	Insulator Bushing (not shown)
28.	62575-002	Chamber/Manifold - HSG200 6" (152.4mm)
	62575-001	Chamber/Manifold - HSG400 6 1/4" (158.75 mm)
	62575-014	Chamber/Manifold - HSG200 9" (228.6mm)
	62575-012	Chamber/Manifold - HSG400 9" (228.6mm)
	62575-026	Chamber/Manifold - HSG200 12" (304.8mm)
	62575-024	Chamber/Manifold - HSG400 12" (304.8mm)
	62575-031	Chamber/Manifold - HSG400 15" (381 mm)
29.	62419-001	Clip, Electrode Bracket
30.	61951-001	Ignitor Support Parts Kit
31.	62411-028	11" (279.4mm) Sensor Wire - 6" (152.4mm), 6 1/4" (158.75mm) Burner
	62411-030	14" (355.6mm), Sensor Wire - 9" (228.6mm), 12" (304.8mm) Burner
	62411-068	17" (431.8mm), Sensor Wire - 15" (228.6mm) Burner
	64096-001	Sense Wire - 330mm Cable (220V/50Hz)
32.	62909-001	8" (203.2mm) Ignition Wire - 6" (152.4mm), 6 1/4" (158.75mm) Burner
	62909-003	14" (355.6mm) Ignition Wire - 9" (228.6mm), 12" (304.8mm) Burner, 15" (228.6mm) Burner
	64095-001	Ignition Wire - 500mm Cable (220V/50Hz)
33.	62404-002	Top Plate/Housing Cover
34.	62304	Strain Relief Bushing/Ignition Wire
35.	62402-001	Orifice Housing
36.	62410-001	Orifice Spring
37.	62401-001	Orifice Gasket
38.	62385-001	Orifice Cap
39.	62374-004	Gas Valve Honeywell VR8305M 4801
40.	62459-001	Orifice Package - HSG200 (not shown)
	62459-002	Orifice Package - HSG400 (not shown)
41.	21760-001	Optional Pedestal Mounting (not shown)

Used with Primary safety Control P/N 62758-002 (Special limit applications only)
--

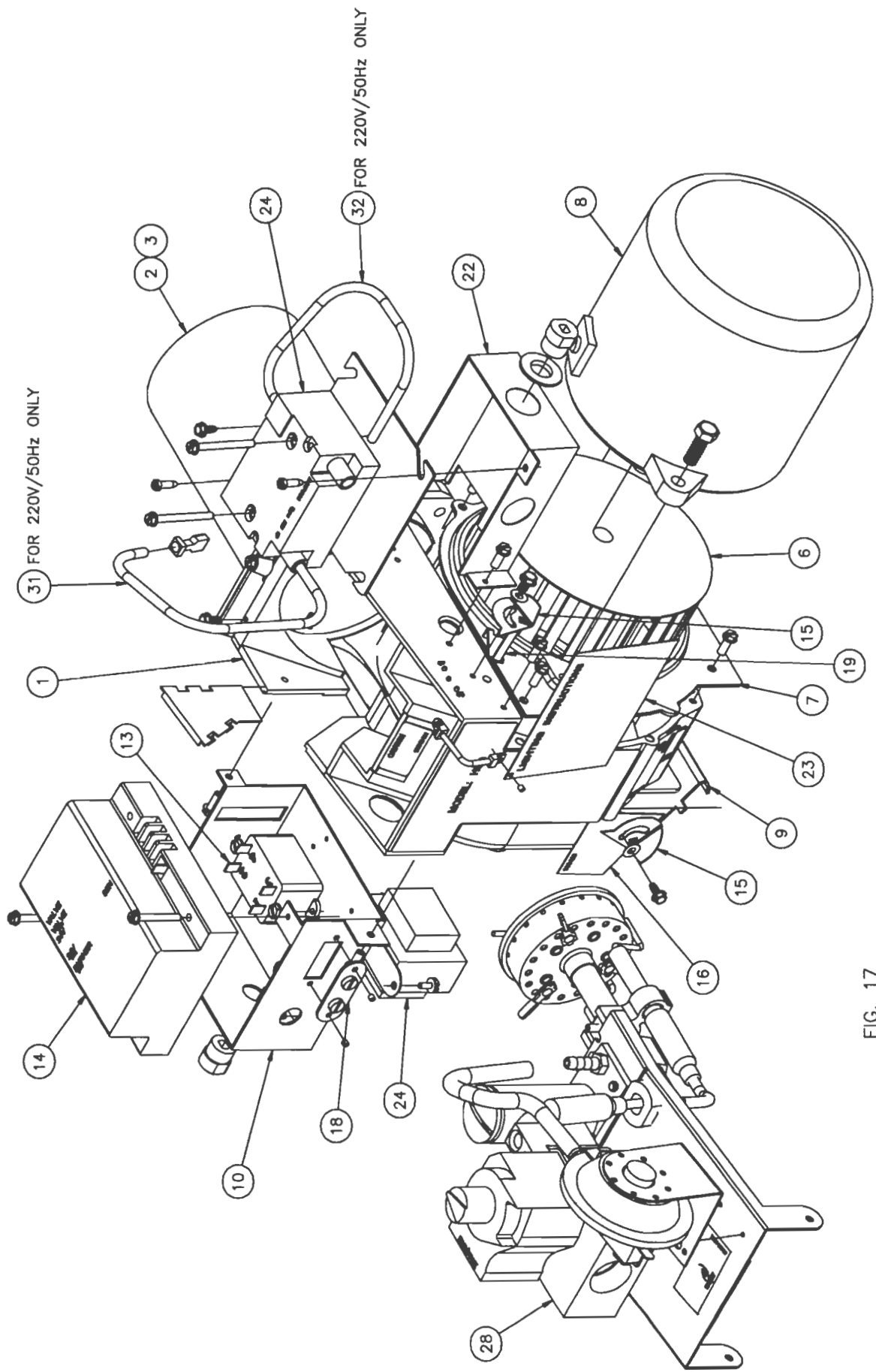

FIG. 17