

Light-Medium Duty Rigid Plate Casters

Specifications:

- Light-medium duty casters, up to 600 lb (272 kg), are **used by businesses, as well as for light equipment in offices, homes institutions and schools.**
- They are used on such products as food service racks, dollies, mobile carts and clothes baskets. Medium duty casters are recommended for manual operation on smooth surfaces.



Rigid Plate
7418

Rigid Plate Caster Specifications

Models 749

Tread Width – 1¼" (38 mm)
Bearing – Nylon
Load Height – 4" (102 mm)

Models 7418

Tread Width – 1¼" (32 mm)
Bearing – Ball
Load Height – 5" (127 mm)

Models 742

Tread Width – 1¼" (32 mm)
Bearing – Nylon
Load Height – 5½" (130 mm)

Models 743A

Tread Width – 1¼" (32 mm)
Bearing – Ball
Load Height – 6¼" (159 mm)

Models 743

Tread Width – 1¼" (32 mm)
Bearing – Nylon
Load Height – 6¼" (159 mm)

Models 744

Tread Width – 1¼" (32 mm)
Bearing – Plain
Load Height – 6¼" (159 mm)

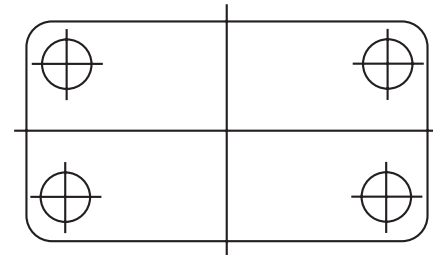

Overall Size3⅛" x 4⅛"
Hole Spacing1¾" to 2⅛"
to 3⅜"
Attached Bolt Size⅜"

Complete Caster Unit includes assembled wheel and rig.

Rigid Plate Casters

Model Number	Ordering Number	Wheel Type	Diameter		Capacity	
			(in)	(mm)	(lb)	(kg)
749	123561	Rubber	3	76	210	95
7418	123369	Polyurethane	4	102	275	125
742	123393	Rubber	4	102	225	102
743A	128792	Polyurethane	5	127	400	181
743	123422	Rubber	5	127	200	91
744	123449	Polyolefin	5	127	300	136

Freight Class: 65

Medium Duty Swivel & Rigid Stem Casters



Rubber Swivel Stem

Specifications:

- Medium duty stem casters, up to 500 lb (227 kg), are used for slightly heavier duty **applications: such as processing carts, platter carts, tote carts, stocking and marking carts, linen carts, heavier food service equipment and order picking trucks.**
- Medium duty stem casters are recommended for manual operation on smooth surfaces.



Square Swivel Stem 757



Swivel Stem Caster 750

Caster Specifications

Models 757, 7548, 756 and 7537

- Tread Width – 1¼" (32 mm)
- Bearing – Ball
- Load Height – 6¼" (159 mm)
- Swivel Radius – 4" (102 mm)

Model 751

- Tread Width – 1¼" (32 mm)
- Bearing – Plain
- Load Height – 6¼" (159 mm)
- *Swivel Radius – 6" (152 mm)

Model 753

- Tread Width – 1¼" (32 mm)
- Bearing – Nylon
- Load Height – 6¼" (159 mm)
- *Swivel Radius – 6" (152 mm)

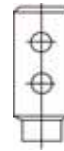

Round Stem
3/16" x 1 9/16" with two cross drilled 5/16" holes.



Square Stem
27/32" x 2 1/2" with 13/64" or 13/32" hole 1 1/4" above upper cup.

Thread Stem
½ - 13 x 1 5/8".

Superglide Caster Model (750) with outstanding Benefits:

- Quieter, Cushioned roll-Non-Marking - 4" x 1" wheel
- Impervious to oil and grease
- Thermoplastic rubber tier bonded to polyolefin center which will never rust.
- Caged bearing and zerk fitting are standard.
- 7/16" Diameter Stem

Swivel Stem Casters

Model Number	Ordering Number	Wheel Type	Stem Style	Diameter		Capacity	
				(in)	(mm)	(lb)	(kg)
750	240565	Superglide ThermoPlastic Rubber Wheel	Grip Ring	4	101	110	50
757	123684	Polyurethane	13 / 64 Square	5	127	400	181
7548	123650	Polyurethane (heavy duty)	Round	5	127	500	227
756	123676	Polyurethane (heavy duty)	Threaded	5	127	500	227
753	123625	Rubber	13 / 64 Square	5	127	200	91
751	123588	Polyolefin	13 / 64 Square	5	127	300	136
Rigid Stem Casters							
7537	214990	Polyurethane (heavy duty)	Round	5	127	500	227

Prices subject to change without notice.

Freight Class: 65

Heavy Duty Swivel Plate Casters

Specifications:

- Heavy Duty casters, up to 1,500 lb. (680 kg), are used for **commercial and industrial applications**. They are operated manually or by intermittent power under 3 mph.
- They are used on relatively smooth surfaces such as concrete which may have minor obstacles.



Swivel Plate Caster
7316

Swivel Plate Caster Specifications

Models 7321CB2

- Tread Width – 2" (51 mm)
- Bearing – HD Cage Roller
- Load Height – 6½" (165 mm)
- Swivel Radius – 4⁵/₁₆" (110 mm)

Models 73161, 7316

- Tread Width – 2" (51 mm)
- Bearing – HD Cage Roller
- Load Height – 9½" (241 mm)
- Swivel Radius – 6½" (165 mm)

Overall Size 4" x 4½"
Hole Spacing 2⁵/₈" x 3⁵/₈"
Attached Bolt Size 3/8"

Models 7313, 7324CB2

- Tread Width – 2" (51 mm)
- Bearing – HD Cage Roller
- Load Height – 7½" (191 mm)
- Swivel Radius – 5⁵/₁₆" (129 mm)

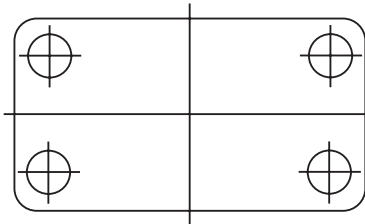

Swivel Plate Caster
7313

Swivel Plate Casters

Model Number	Ordering Number	Wheel Type	Diameter		Capacity	
			(in)	(mm)	(lb)	(kg)
7321CB2	123086	Mold-On Polyurethane	5	127	1,000	454
7313	122999	Mold-On Polyurethane	6	152	1,200	544
7324CB2	246641	Mold-On Rubber	6	152	410	186
73161	123035	Mold-On Polyurethane	8	203	1,400	635
7316	123027	Mold-On Rubber	8	203	500	227

Freight Class: 65

Heavy Duty Rigid Plate Casters



Rigid Plate Caster
7451

Specifications:

- Heavy Duty casters, up to 1,500 lb (680 kg), are used for **commercial and industrial applications**. They are operated manually or by intermittent power under 3 mph.
- They are used on relatively smooth surfaces such as concrete which may have minor obstacles.

Rigid Plate Caster Specifications

Models 7451 and 745CBZ
Tread Width – 2" (51 mm)
Bearing – HD Cage Roller
Load Height – 6½" (165 mm)

Models 7465 and 7462
Tread Width – 2" (51 mm)
Bearing – HD Cage Roller
Load Height – 7½" (191 mm)

Models 7471 and 7411
Tread Width – 2" (51 mm)
Bearing – HD Cage Roller
Load Height – 9½" (241 mm)

**Available with:
5", 6" and 8" Mold-On
Polyurethane Wheels
or
6" and 8" Mold-On
Rubber Wheels**

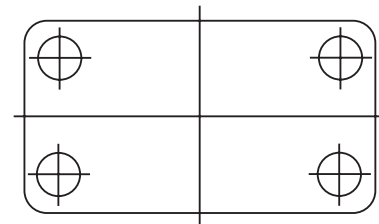

Overall Size 4" x 4½"
Hole Spacing 2⅝" x 3⅝"
to 3" x 3"
Attached Bolt Size ⅜"

Rigid Plate Casters

Model Number	Ordering Number	Wheel Type	Diameter		Capacity	
			(in)	(mm)	(lb)	(kg)
7451	123473	Mold-On Polyurethane	5	127	1,000	454
745CBZ	123465	Mold-On Rubber	5	127	375	170
7465	123502	Mold-On Polyurethane	6	152	1,200	544
7462	123490	Mold-On Rubber	6	152	410	186
7471	123537	Mold-On Polyurethane	8	203	1,400	635
7411	123300	Mold-On Rubber	8	203	500	227

Prices subject to change without notice.

Freight Class: 65

Polyurethane Wheels

Long Life And Low Maintenance Polyurethane Wheels Are Ideal For Heavy Duty Applications!

Precision molded tread is mechanically interlocked to a ribbed polyolefin core. The core contributes to the wheel's high impact strength.

Wheel Specifications:

Models 7125 and 7112

Tread Width – 1¼" (32 mm)

Axle Size – ¾" (10 mm)

Hub Length – 1⅝" (41 mm)

Models 7128, 7129 and 7130

Tread Width – 2" (51 mm)

Hub Length – 2⅜" (56 mm)

Model 71121

Tread Width – 1¼" (32 mm)

Axle Size – ⅝" (8 mm)

Hub Length – 1⅝" (41 mm)

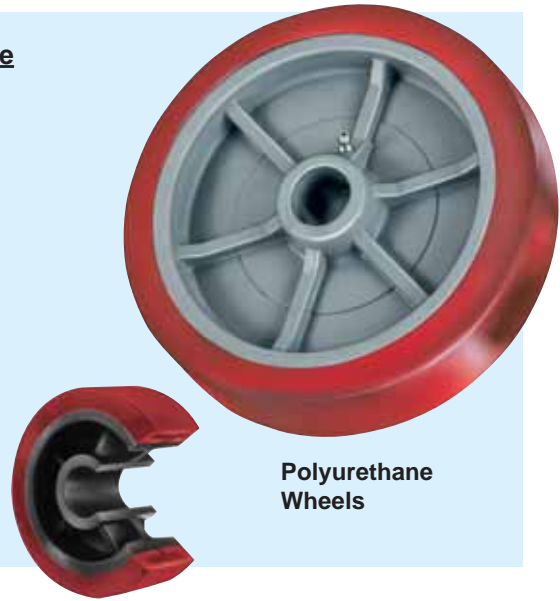

**Polyurethane
Wheels**

Polyurethane Wheels

Model Number	Ordering Number	Wheel Type	Diameter		Capacity	
			(in)	(mm)	(lb)	(kg)
7125	122403	Ball	4	102	275	125
7112	122180	Ball	5	127	400	181
71121	122198	Ball	5	127	400	544
7128	122438	Roller	5	127	700	317
7129	122446	Roller	6	152	800	363
7130	122462	Roller	8	203	900	408

Freight Class: 65

Solid Rubber Wheels

Solid Rubber tread. Wheels are molded of high standard non-marking rubber compounds. **Rubber wheels are shock absorbent and are recommended for normal loads where noise is a factor.**

Wheel Specifications

Model 718

Tread Width – 1¼" (32 mm)

Axle Size – ¾" (10 mm)

Hub Length – 1⅜" (35 mm)

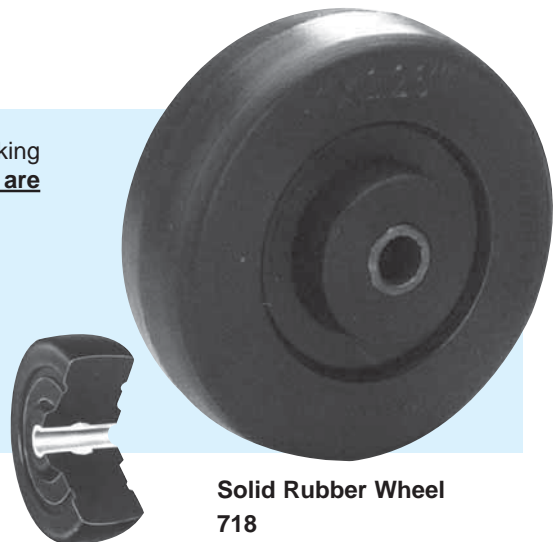

**Solid Rubber Wheel
718**

Solid Rubber Wheels

Model Number	Ordering Number	Wheel Type	Diameter		Capacity	
			(in)	(mm)	(lb)	(kg)
718	122690	Nylon	5	127	260	118

Freight Class: 65

Polyolefin Wheels



Polyolefin
Wheels



Solid Polyolefin design. Injection molded of durable thermo-plastics, these wheels withstand high impacts and offer resistance to most chemicals, solvents, oils, grease and acids. **Ideal for situations where heavy loads and mobility are factors. Ideal for indoor applications over smooth rolling surfaces.**

Wheel Specifications:

Model 717
Tread Width – 1¼" (32 mm)
Axle Size – 3/8" (10 mm)
Hub Length – 1½" (38 mm)

Model 717
Tread Width – 2" (51 mm)
Axle Size – ½" (mm)
Hub Length – 2³/₁₆" (mm)

Polyolefin Wheels

Model Number	Ordering Number	Wheel Type	Diameter		Capacity	
			(in)	(mm)	(lb)	(kg)
717	122681	Plain	5	127	300	136
7120	122358	Roller	6	152	700	317

Freight Class: 65

Mold-On Polyurethane Wheels



Mold-On
Polyurethane
Wheels



Heavy Duty Applications Designed For Extra Strength! Polyurethane tread bonded to heavy duty steel core. This wheel is designed for extra strength. They are used when conditions call for extreme weight loads and high impacts. **Long life and low maintenance polyurethane wheels are excellent for heavy duty applications and all rolling surfaces.** Wheel includes cage roller bearing.

Wheel Specifications:

All Models
Tread Width – 2" (51 mm)
Hub Length – 2³/₁₆" (56 mm)

Mold-On Polyurethane Wheels

Model Number	Ordering Number	Wheel Type	Diameter		Capacity	
			(in)	(mm)	(lb)	(kg)
7123	122382	Roller	5	127	1,000	454
7115	122260	Roller	6	152	1,200	544
7116	122294	Roller	8	203	1,500	680

Freight Class: 65

Prices subject to change without notice.

Mold-On Rubber Wheels

Rubber tread bonded to steel core. **Heavy duty rubber tread design provides maximum floor protection and quiet operation. Ideal for all rolling surfaces.** Wheel includes bearing.

Wheel Specifications

All Models

- Tread Width – 2" (51 mm)
- Hub Length – 2³/₁₆" (56 mm)



Mold-On Rubber Wheels

Mold-On Rubber Wheels

Model Number	Ordering Number	Wheel Type	Diameter		Capacity	
			(in)	(mm)	(lb)	(kg)
7113	122235	Roller	5	127	375	170
711	122155	Roller	6	152	410	186
712	128750	Roller	8	203	1,000	454

Freight Class: 65

Phenolic and High Temp Phenolic Wheels

Molded macerated fabric with phenolic resin plastic. This hard tread wheel is designed for heavy load capacities and offers easy mobility over smooth surfaces and floor protection. The operation of the wheel is quieter than steel wheels and is resistant to most chemicals. **High Temp Wheels are ideal for oven racks!** Wheel includes bearing.

Wheel Specifications

Models 7119 and 7114

- Tread Width – 2" (51 mm)
- Bearing – Roller
- Hub Length – 2³/₁₆" (56 mm)

Models 71181

- Tread Width – 1½" (38 mm)
- Bearing – Plain
- Axle Size – 3/8" (10 mm)
- Hub Length – 1⁵/₈" (41 mm)



Phenolic Wheels

Now! all of our oven racks can be ordered with our quick release caster system (add \$4 to list price per wheel) (patent pending)

- Allows easier & faster cleaning
- Fast replacement of wheels
- NSF approved
- Stainless & Aluminum Materials
- Use with any medium duty plate caster

Phenolic Wheels

Model Number	Ordering Number	Wheel Type	Diameter		Capacity	
			(in)	(mm)	(lb)	(kg)
7119	122331	Phenolic	6	152	1,200	544
7114	122243	Phenolic	8	203	1,400	635
71181	122323	Super High Temp. Phenolic	4	102	600	272

Freight Class: 65

Hand Truck Wheels

Model 715 is a Mold-On Rubber tread locked to an aluminum core. Heavy duty rubber tread provides maximum floor protection. Ideal for rolling surfaces.

Model 714 is a semi-pneumatic solid rubber tire on a steel wheel disk. Maneuvers easily on all surfaces. Wheel includes bearing.

Wheel Specifications

Model 715

- Tread Width – 1⁵/₈" (41 mm)
- Bearing – Ball
- Axle Size – ⁵/₈" (16 mm)
- Hub Length – 2" (51 mm)

Model 714

- Tread Width – 2³/₄" (70 mm)
- Bearing – Ball
- Axle Size – ⁵/₈" (16 mm)
- Hub Length – 3" (76 mm)



Mold-On Rubber tread locked to an aluminum core Model #715



Semi-Pneumatic Solid Rubber tire on a steel wheel disc. #714

Model Number	Ordering Number	Wheel Type	Diameter		Capacity	
			(in)	(mm)	(lb)	(kg)
715	122665	Mold-On Rubber	8	203	450	204
714	128768	Semi-Pneumatic	10	254		

Freight Class: 65

Prices subject to change without notice.